

## WRU01加长型圆导轨滑块 Round rail sliding blocks(long design)



### 产品特性 Product features

- 安装2个标准滑动膜EPB13, 可选铝轴滑动膜MN2
- 承载能力是标准型的2倍
- 自润滑、免维护
- 重量轻、快速装配
- 可用于WR系列单轨和双轨
- 抵抗灰尘
- 无噪音运行
- Assembled 2pcs standard liners EPB13, MN2 liners for aluminum shafts
- Carrying capacity is twice that of the standard type
- Maintenance-free, dry-running
- Fast assembly and light weight
- For WR single and dual guide rails
- Resistant dust
- Silent operation

### 标准规格 Standard specifications

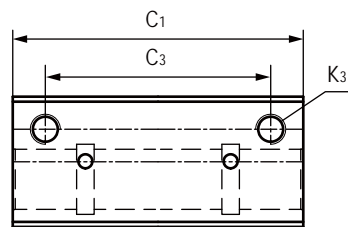
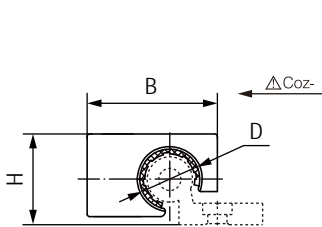

产品编码 Part No.:

WRU01-10-MN2-L-NA

- NA:本色 Nature color  
空白 Blank:深灰色 Dark grey
- 加长型设计 Long design
- 材料 Material:MN2  
空白 Blank:EPB13
- 内径 Inner diameter

产品编码 Part No.	D [mm]	公差 Tolerance [mm]	B [mm]	C <sub>3</sub> [mm]	C <sub>1</sub> [mm]	H [mm]	K <sub>3</sub> [mm]	重量 Weight [g]	静态载荷 Static load		
									Coy- [N]	Coz+ [N]	Coz- [N]
WRU01-10-L-NA	10	+0.083/+0.020	26	45	58	18	M6	40	2400	2400	500
WRU01-16-L-NA	16	+0.102/+0.032	34.5	54	72	27	M8	96	4200	4200	800
WRU01-20-L-NA	20	+0.124/+0.040	42.5	72	90	36	M8	198	6400	6400	1000
WRU01-10-MN2-L-NA	10	+0.083/+0.020	26	45	58	18	M6	40	2400	2400	500
WRU01-16-MN2-L-NA	16	+0.102/+0.032	34.5	54	72	27	M8	96	4200	4200	800
WRU01-20-MN2-L-NA	20	+0.124/+0.040	42.5	72	90	36	M8	198	6400	6400	1000